

# WANCO

## TRAFFIC SAFETY



800-972-0755  
www.wanco.com



Wanco headquarters and 265,000 square-foot factory located in Arvada, Colorado.

## At Wanco, we are committed to making the industry better.

Founded in 1984, Wanco celebrates 40+ years of innovation and manufacturing by expanding yet again, adding another production facility (see inset), broadening our product offering and further increasing our manufacturing capacity.

With a reputation for service and integrity, we are proud to be the industry's leading manufacturer of highway safety and traffic control products. To learn more, visit us online at [wanco.com](http://wanco.com) or contact us by calling 1-800-972-0755.

We look forward to serving you.

Orders • Parts • Service • Support

# 800-972-0755

[info@wanco.com](mailto:info@wanco.com)



We're growing! New 75,000 square-foot production expansion.



Wanco is proud to be a member of the American Traffic Safety Services Association, and an associate member of the American Rental Association.

Due to Wanco's commitment to continuous improvement of our products and services, all information is subject to change without notice. Wanco, W|ECO, and the Wanco and W|ECO logos are registered trademarks, and Metro and X-Marker are trademarks, of Wanco Inc. All other trademarks are property of their respective owners.

# Product Models

## Variable Message Sign Trailers Pages 6 – 7



Full-Size Matrix  
WTMMB



Mini Matrix  
WVTM



Metro™ Compact Matrix  
Large sign WVTMM-L  
Medium sign WVTMM-M



Full-Size Remote-Video Monitoring System  
WTMMBC



Mini Remote-Video Monitoring System  
WVTMC



Full-Size Three-Line  
WTLMB



Mini Three-Line  
WVT3

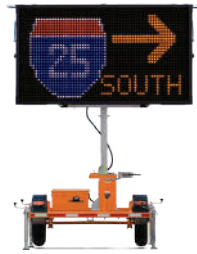

5-Color Matrix  
WVTM-5C



MTO Oversize Matrix  
MTMMB-MTO



International  
WEMB

## Truck-Mount Message Signs Pages 6 – 7



Matrix Signs for Large Trucks  
Large Sign WMBV-FL  
Medium Sign WMBV-FM



Matrix Signs for Small Trucks  
Medium Sign WWMB-3LP  
Small Sign WWMB-2LP

## Pole-Mount Message Signs



Full Matrix  
Battery/Solar  
Commercial AC Power



Three-Line  
Battery/Solar  
Commercial AC Power

## Conversion Kits Page 23



Full-Matrix Kits  
Full Size  
Mini  
Metro Large  
Metro Medium



Three-Line Kits  
Full Size  
Mini

## Connected Systems Pages 8 – 9



# Product Models

## Arrow Board Trailers Pages 10 – 11



Folding Frame

WTSP



Vertical Mast

WTSPV



MTO

WTSP-LSA-MTO



Standard Skid

WSSP



Low-Profile Skid

WSSP-LP



Rigid Skid

WS1SB8

## Truck-Mount Arrow Boards Pages 10 – 11



No Mounting Frame

48 × 96 in. WB8  
36 × 72 in. WB6  
30 × 60 in. WB5  
24 × 48 in. WB4



Manual Tilt (Auto-Lock)

48 × 96 in. WFB8  
36 × 72 in. WFB6  
30 × 60 in. WFB5  
24 × 48 in. WFB4



90° Power-Tilt Frame

48 × 96 in. WFBP8  
36 × 72 in. WFBP6  
30 × 60 in. WFBP5  
24 × 48 in. WFBP4



Low-Profile 90° Power-Tilt Frame

36 × 72 in. WLP90B6  
30 × 60 in. WLP90B5



180° Power-Tilt Frame

36 × 72 in. WFP180B6  
30 × 60 in. WFP180B5



Tailgate Mount

48 × 96 in. WVGB8  
36 × 72 in. WVGB6  
30 × 60 in. WVGB5  
24 × 48 in. WVGB4



Truck-Bed Mounts

Mounting brackets (pair)  
Tall mounting frame  
Low mounting frame



Arrow-Shaped Signs

No frame WSBLA-14  
Manual tilt (auto-lock) frame WFBLA-14  
Low-profile frame WFBLA-14LP

## VSL Page 13



Variable Speed Limit

WVSL



Compact

WSDT3-S



Vertical Mast

WSDTV



Folding Frame

48 × 60 sign WSDTF-60  
36 × 48 sign WSDTF-48



International

WSDT3-EU



Pole Mount

26 × 26 display WSDP3  
24 × 30 display WSDP1

## Radar Speed Signs Pages 14 – 15

Light Towers Pages 18 – 20



Solar  
WLTS



Compact Diesel  
WLTT



Laydown Diesel  
WLT



Balloon Light Cart  
WLC1000B

Camera Trailers Page 17



Mini Solar Surveillance  
WCTS-MINI



Traffic Solar Surveillance  
WCTS-DOT

AFAD Page 12

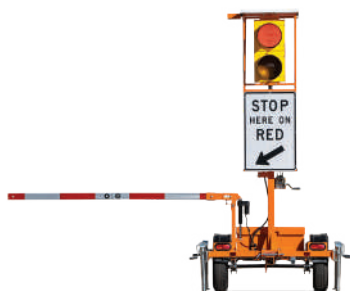

Automated Flagger Assistance Device  
WAFD

Beacon Trailers Page 22

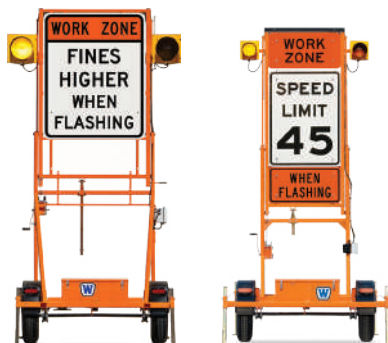

Flashing Beacon Trailers  
48-inch width signs WFNG-48-2L  
36-inch width signs WFNG-36-2L

Beacons Page 23

Caution Beacon Kits and Components



Accessories Pages 16, 23



Accessories  
Asset Tracker    Speed Radar  
Cellular Service    Traffic Data Collector  
Compass

Mobile Generators Page 22



Mobile Generator Trailers & Skids  
WSP Series  
Selection of models from 12 kW and up

X-Marker Page 21

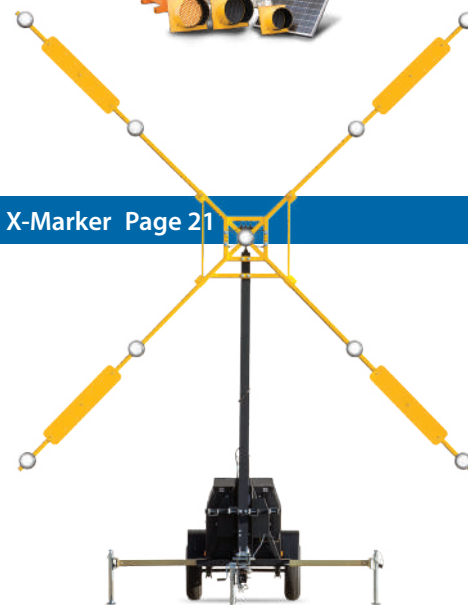

X-Marker™ L-893(L) Runway Closure Marker  
WTRC

# Variable Message Signs

## Full Matrix and Three-Line

Many sizes and configurations

Every sign has an onboard controller

Easiest programming in the industry

Low power consumption

All signs are NTCIP compliant

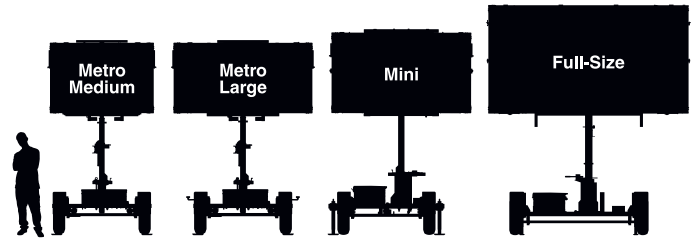

Wanco® Variable Message Signs are the safest means for notifying motorists of changes in traffic patterns and road conditions. Also known as portable changeable message signs, Wanco signs are ultra-bright and highly legible. They include a variety of functions for any application—lane closures, highway construction, work zones, special events and more. A choice of sizes, displays, functions and other options make these signs extremely versatile.



Full-Size Matrix Sign  
Model WTMMB



Medium Metro™ Matrix Sign  
Model WVTMM-M



Full-Size Three-Line Sign  
Model WTLMB



Mini Remote-Video  
Monitoring System  
Model WVTMC



Wanco's full-color touchscreen controller provides access to all message sign functions. Widely known as the industry's easiest to use, features include capacitive response, multilevel password protection, large virtual buttons and easy message selection.

|                      |           | Matrix signs*         |                      | Three-line signs        |                         | Metro™ compact signs |                      | 5-color sign†         | Large-truck signs*  |                     |
|----------------------|-----------|-----------------------|----------------------|-------------------------|-------------------------|----------------------|----------------------|-----------------------|---------------------|---------------------|
|                      |           | Full size             | Mini                 | Full size               | Mini                    | Large                | Medium               | Mini                  | Large               | Medium              |
| Deployed footprint   | in. (cm)  | 186 × 138 (473 × 351) | 143 × 96 (362 × 244) | 186 × 138 (473 × 351)   | 143 × 96 (362 × 244)    | 124 × 96 (313 × 244) | 118 × 71 (299 × 180) | 143 × 104 (362 × 264) | 102 × 28 (259 × 71) | 87 × 28 (220 × 71)  |
| Display cabinet size | in. (cm)  | 138 × 75 (351 × 190)  | 96 × 55 (244 × 140)  | 138 × 75 (351 × 190)    | 96 × 55 (244 × 140)     | 96 × 48 (244 × 122)  | 71 × 48 (180 × 122)  | 104 × 59 (264 × 150)  | 97 × 49 (247 × 124) | 82 × 49 (209 × 124) |
| Operating height     | in. (cm)  | 159 (404)             | 142 (361)            | 159 (404)               | 142 (361)               | 134 (340)            | 134 (340)            | 145 (367)             | 56 (142)            | 56 (142)            |
| Travel height        | in. (cm)  | 105 (265)             | 103 (262)            | 105 (265)               | 103 (262)               | 92 (232)             | 92 (232)             | 104 (264)             | 19 (49)             | 19 (49)             |
| Weight, approx.      | lbs. (kg) | 2640 (1193)           | 1580 (717)           | 2640 (1193)             | 1580 (717)              | 1500 (680)           | 1400 (635)           | 1763 (800)            | 390 (177)           | 340 (154)           |
| Display              |           | 48 × 27 pixels        | 48 × 27 pixels       | 3 lines of 8 characters | 3 lines of 8 characters | 60 × 30 pixels       | 48 × 30 pixels       | 60 × 32 pixels        | 56 × 28 pixels      | 48 × 28 pixels      |
| Fonts                |           | 12                    | 12                   | 1                       | 1                       | 12                   | 12                   | 12                    | 12                  | 12                  |
| Power                |           | Batteries, solar      | Batteries, solar     | Batteries, solar        | Batteries, solar        | Batteries, solar     | Batteries, solar     | Batteries, solar      | Vehicle power       | Vehicle power       |

Cabinet and display are W × H. Footprint size is L × W. \*For additional sign sizes, visit [wanco.com](http://wanco.com). †Colors: Red, Blue, Green, Amber, White



5-Color Matrix Sign  
Model WVTM-5C



Large-Truck Matrix Sign (8-Foot)  
Model WMBV-FL

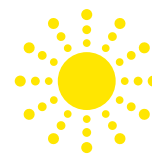

**NEW!** Truck-mount models now available with solar charging option



International Matrix Sign  
Model WEMB



Restore or upgrade your message sign fleet.  
See our Message Sign Conversion Kits on page 23.

# Connected Systems



Remote access and control

ATMS integrations

ITS & Smart Work Zone Systems

Secure VPN connections

Equipment delivered ready to use



Wanco offers safe, time-efficient and financially friendly solutions for active traffic management systems (ATMS), including remote access to traffic data and remote control of equipment. Wanco products and services easily integrate with ITS implementations, smart work zones and ATMS systems.

## Wanco Cellular Private Network



When you want secure remote connections to your Wanco equipment, ask us to configure your system with Wanco Cellular Service.

Industry-leading security is ensured using our virtual private network (VPN) for your cellular and GPS service. Plus, all of your accounts are managed by Wanco and you are billed a single, annual service fee.

Embedded GPS modems and our Verizon® Wireless VPN ensure the highest degree of network security and reliability. Verizon operates the nation's largest 4G LTE network.

Remotely access your Wanco equipment using an Internet-connected computer or mobile device. Monitor, program and run diagnostics from a central office, local command center or the front seat of a work truck. Wanco has a selection of compact industrial 4G gateways with GPS. We set up the modem at the factory for easy integration and no configuration hassles.

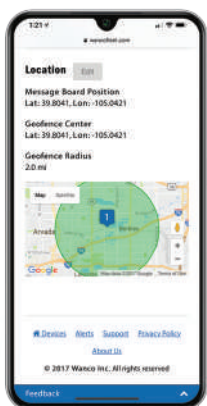

Remote monitoring and diagnostics  
Cellular data transfer technology  
Precision GPS built in  
Programmable alarms  
Compatible with NTCIP central systems

Reliable cellular coverage and GPS service  
Simple and easy setup  
Equipment delivered ready to use  
Additional configuration not required  
Easy annual billing



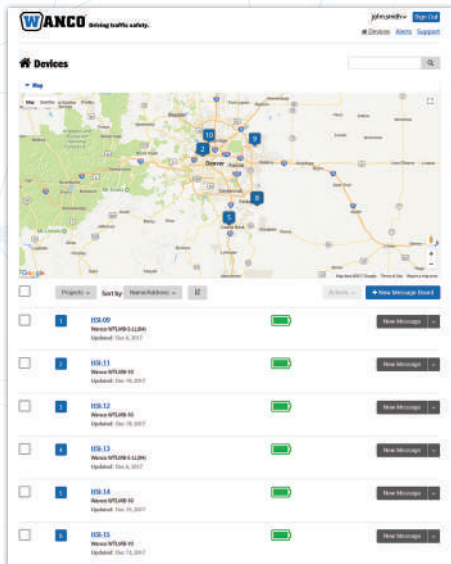

# Wanco Fleet Manager

Wanco Fleet Manager provides the fleet tracking and management solution you need for all your Wanco equipment. With this interactive online tool, you have everything you need for viewing equipment location, compass bearing, display status, voltages and alarms.

- Remote access through the cloud
- Accurate and real-time data
- Message management
- Mass-message broadcast
- Temperature and electrical-system graphs

# Smart Work Zones

Intelligent Transportation Systems (ITS) communicate to drivers through real-time messaging in order to keep them safe and cautious while approaching hazardous work zones. Wanco Smart Work Zones are an effective solution for contractors, even if they are not tech-savvy.

- Provide drivers with real-time traffic updates as they approach a work zone
- Warn in advance of hazards, preventing accidents and saving lives
- Improve safety for construction and transportation workers
- Offer alternate routes, eliminating traffic congestion and pile-ups
- Reduce costs and improve profits through lower accident rates, fuel expenses and emissions



# Connected Devices

Maximize the value of your traffic safety assets. Connect remotely to your Wanco fleet to save time, improve safety and reduce the need for training off-site personnel. Monitor and take control of connected devices based on accurate, up-to-date information.

Wanco Connected Arrow Boards (CABs) send data to the HAAS Alert Safety Cloud®, enabling delivery of real-time digital alerts to connected systems. CABs warn drivers in advance, helping to prevent crashes and improve work zone safety.



# Wireless Control

Enjoy wireless roadside control of Wanco AFADs (Automated Flagger Assistance Devices), wireless arrow boards and wireless message signs. Full functionality is at your fingertips with wireless touchscreen controllers.

- Intuitive and easy to use
- Battery powered and rechargeable
- Full color high-resolution display
- Resistive touchscreen control



# Connected Arrow Boards

## Trailers, Skids & Truck-Mounts

Trailers and skids feature  
**W|ECO**® Technology   
 Learn more at [wanco.com](http://wanco.com)

- 15-light and 25-light models
- Cloud-based digital alerting
- Energy efficient
- Wide selection of truck-mount options
- Easy to operate and maintain



Compact design fits 15 folding arrow boards on a truck

Wanco Connected Arrow Boards play an essential role in keeping the work zone safe. Highly visible and connected to the cloud, rugged and dependable, Wanco Arrow Boards set the standard. Wanco has a full selection of models to fit your specific needs, including solar models with environmentally friendly W|ECO® Technology, the most power-efficient arrow boards in the industry.



**NEW!** All standard arrow boards are now connected MUTCD Types C and B

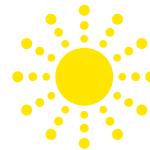

**NEW!** Truck-mount models now available with solar charging option



Folding-Frame Arrow Board Trailer  
 Model WTSP

Truck-Mount Arrow Board  
 and 90° Power-Tilt Frame  
 Model WFBP6

Arrow-Shaped Sign with Low-Profile Tilt Frame  
 Model WFBLA-14 (not connected)

Vertical-Mast Arrow Board Trailer  
 Model WTSV

Low-Profile Skid  
 Model WSSP-LP



**NEW!** Trailer- and skid-mount controllers for connected arrow boards include integrated voltage meter

**NEW!** Truck-mount controllers for connected arrow boards use a single, standard Ethernet connector

Flashing patterns

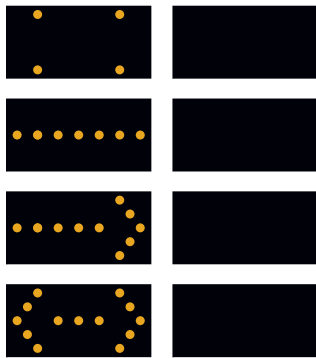

Sequential patterns

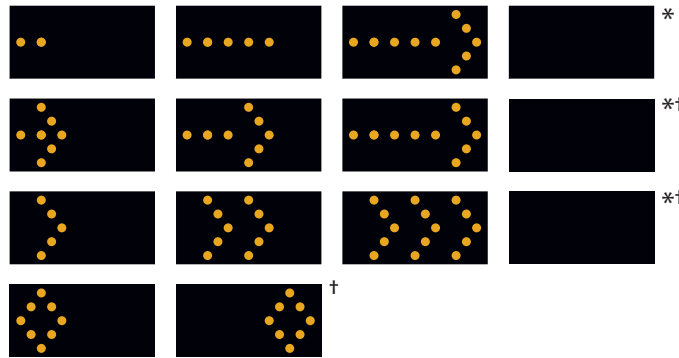

\*Left or right †25-light models only

Real-time digital alerting



Learn more at [wanco.com](http://wanco.com)

|                      | Arrow board trailers |                      | Arrow board skids    |                     |                     | Truck-mount arrow boards* |                                  |                    |                    |                    |
|----------------------|----------------------|----------------------|----------------------|---------------------|---------------------|---------------------------|----------------------------------|--------------------|--------------------|--------------------|
|                      | Folding              | Vertical             | Standard             | Low profile         | Rigid               | Full size                 | Large                            | Medium             | Small†             |                    |
| MUTCD standard       | Type C               | Type C               | Type C               | Type C              | Type C              | Type C                    | Type B                           | Type B             | Type A             |                    |
| Display cabinet size | in. (cm)             | 48 × 96 (122 × 244)  | 48 × 96 (122 × 244)  | 48 × 96 (122 × 244) | 48 × 96 (122 × 244) | 48 × 96 (122 × 244)       | 36 × 72 (92 × 183)               | 30 × 60 (76 × 153) | 24 × 48 (61 × 122) |                    |
| Deployed footprint   | in. (cm)             | 121 × 96 (307 × 244) | 131 × 96 (332 × 244) | 54 × 96 (137 × 244) | 58 × 96 (146 × 244) | 36 × 96 (91 × 244)        | Varies depending on installation |                    |                    |                    |
| Operating height     | in. (cm)             | 133 (337)            | 132 (336)            | 116 (295)           | 85 (216)            | 75 (189)                  | Varies depending on installation |                    |                    |                    |
| Travel height        | in. (cm)             | 85 (215)             | 90 (229)             | 71 (180)            | 38 (96)             | 75 (189)                  | Varies depending on installation |                    |                    |                    |
| Weight, approx.      | lbs. (kg)            | 1250 (567)           | 1250 (567)           | 540 (245)           | 520 (236)           | 320 (145)                 | 112 (51)                         | 100 (45)           | 72 (33)            | 42 (19)            |
| Display lamps        |                      | PAR 46 LED           | PAR 46 LED           | PAR 46 LED          | PAR 46 LED          | PAR 46 LED                | PAR 46 LED                       | PAR 46 LED         | PAR 36 LED         | PAR 36 LED         |
| Power                |                      | Batteries, solar     | Batteries, solar     | Batteries, solar    | Batteries, solar    | Batteries, solar          | Vehicle alternator               | Vehicle alternator | Vehicle alternator | Vehicle alternator |

Cabinet size is H × W. Footprint size is L × W. \*For arrow-shaped signs and additional sizes, visit [wanco.com](http://wanco.com). †This model is not connected.

# Automated Flagger

Moves human flagger away from traffic

Remote control—wireless and cabled both included

Intuitive easy-to-use controllers

Battery powered and solar charging

Tandem tow or nested tow

The Wanco AFAD addresses worker safety by moving the human flagger off the road, away from the flow of traffic. Operated by remote control, one worker can manage one or two AFADs from a safe distance, limiting exposure and liability. Tandem towing is standard, where allowed by local regulations. Nested dual-tow is optional, allowing two units to be towed as one.



Automated Flagger Assistance Device shown with optional orange safety flag Model WAFD

Wireless and cabled controllers are both included, orange safety flag is optional

| Brief Specifications |  |
|----------------------|--|
| Signal lights        | 12-inch LED modules<br>Red top light and yellow bottom light   |
| Regulatory sign      | Standard R10-6 "STOP HERE ON RED" sign<br>24" x 36" (61 x 91 cm) W x H<br>White high-intensity reflective coating                        |
| Gate arm             | Rectangular PVC tubing, 3 x 2 1/8 in. (7.6 x 5.4 cm) H x D<br>Vertical red-and-white stripes<br>Optional arm sizes and stripes available |
| Alarm                | 1-tone intrusion siren, 110 dB   |
| Wireless controller  | 4.3-inch resistive touchscreen display<br>1000 ft. (305 m) range from controller to AFAD trailer   |
| Cabled controller    | Single push-button<br>Quick-connect 15 ft. (4.6 m) cable   |
| Power                | Batteries, solar   |



Drawbar tandem tow with two drawbars and hitches



Optional nested dual tow with one drawbar and hitch

# Variable Speed-Limit Trailers

Portable self-powered system

Extra-large electronic display

Selectable LED speed numbers

Display speed as white-on-black or black-on-white

Remotely accessible and changeable with Wanco 4G modem

Wanco Variable Speed-Limit Trailers display a changeable speed limit on a sign that mimics the look of a regulatory speed limit sign. Change the speed limit locally or remotely—in real time, by responding to current traffic, weather and road conditions—without changing or adding infrastructure.

Variable speed limit signs provide dynamically changeable speed limit notification to motorists on a brightly lit, highly visible LED display. Wanco Variable Speed Limit Trailers add flexibility to this strategy, being both portable and self-powered. They are easy to deploy and require no permanent installation or wiring. Power is provided by batteries that are charged by an automated solar charging system.

The display is capable of showing white numbers on a black background and black numbers on a white background, two digits for mph and three digits for km/h. Automatic dimming helps to ensure long run times. Customizations are available to meet local specifications.

| Brief specifications    |   |
|-------------------------|---|
| R2-1 sign, W×H          | 36×48 in. (91×122 cm)   |
| Deployed footprint, L×W | 131×96 in. (332×244 cm)   |
| Operating height        | 15 ft. 4 in. (4.67 m)   |
| Travel height           | 97 in. (247 cm)   |
| Weight, approx.         | 1560 lbs. (708 kg)  |
| LED speed display       | Configurable, from 5 to 140, in increments of 5<br>Character height, 18 in. (46 cm)<br>Selectable, white on black or black on white |
| Power                   | Batteries, solar  |



Speed limit can be displayed white on black or black on white

Variable Speed Limit Trailer  
Model WWSL

# Radar-Speed Signs Trailers & Pole-Mounts

Large, bright LED characters

Easy to transport

Changeable speed-limit sign

See-through design

Battery and solar powered

Featuring the largest portable speed-display available, Wanco Radar-Speed Signs show vehicle speed in 26-inch characters, warning motorists to slow down by flashing their excessive speed. Commonly deployed in school zones, work zones and high-accident areas, these signs provide a degree of traffic calming unmatched by other roadway signs.

 Custom sign colors are available as options.

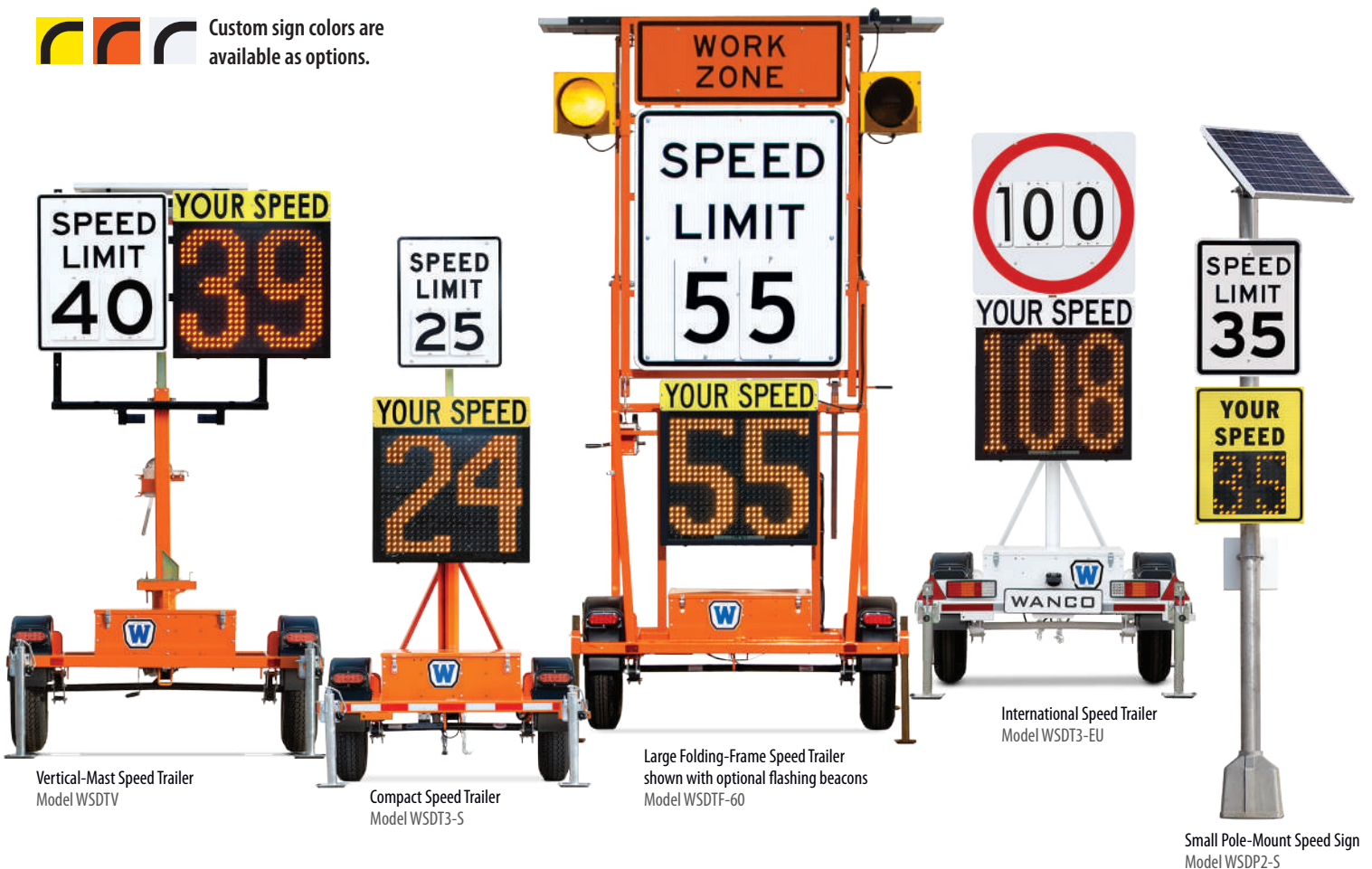

# Touchscreen Controller



Wanco's full-color touchscreen controller\* provides access to all speed sign functions. Widely known as the industry's easiest to use, features include capacitive response, large virtual buttons and easy message setup.

\*Standard speed signs have an analog controller; the touchscreen is an optional upgrade. When a speed trailer is ordered from the factory with Data Classifier System, the touchscreen is included.

## Touchscreen Features

- Capacitive touchscreen with instantaneous response
- Single-press to access most common settings
- Change settings and view system status from main screen
- Set any speed and excess speed independently
- Display vehicle speeds or messages
- Create custom messages
- Choose from preprogrammed messages
- Internal clock for built-in scheduling
- Set up connected devices, including Wanco Traffic Data Classifier System (see page 16)
- Multi-level password protection restricts access to authorized personnel
- Main screen shows message on sign, speed settings, radar and classifier status
- Access system information, power levels, active alarms and system settings from main screen
- Turn connected devices on and off, including radar, classifier, beacons and more

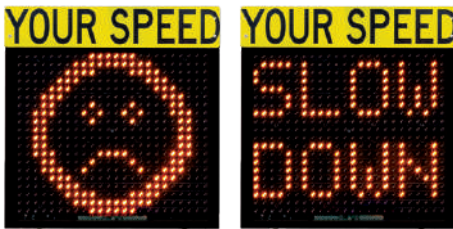

Custom and preprogrammed messages

|                         | Radar-speed trailers |                         |                         |                         |                         | Pole-mount speed signs  |                                   |                                 |
|-------------------------|----------------------|-------------------------|-------------------------|-------------------------|-------------------------|-------------------------|-----------------------------------|---------------------------------|
|                         | Vertical Mast        | Compact                 | Folding frame, large    | Folding frame, small    | International           | Large                   | Small                             |                                 |
| Deployed footprint      | in.<br>(cm)          | 118 × 77<br>(299 × 195) | 106 × 60<br>(268 × 152) | 127 × 75<br>(323 × 191) | 130 × 82<br>(330 × 208) | 106 × 60<br>(268 × 152) | —                                 | —                               |
| Operating height        | in.<br>(cm)          | 134<br>(340)            | 123<br>(312)            | 162<br>(412)            | 154<br>(392)            | 123<br>(312)            | —                                 | —                               |
| Travel height           | in.<br>(cm)          | 92<br>(234)             | 91<br>(231)             | 105<br>(267)            | 102<br>(260)            | 91<br>(231)             | —                                 | —                               |
| Weight, approx.         | lbs.<br>(kg)         | 1250<br>(567)           | 870<br>(395)            | 1300<br>(590)           | 1170<br>(531)           | 870<br>(395)            | —                                 | —                               |
| Display cabinet size*   | in.<br>(cm)          | 36 × 38<br>(91 × 96)    | 36 × 38<br>(91 × 96)    | 36 × 38<br>(91 × 96)    | 36 × 38<br>(91 × 96)    | 36 × 38<br>(91 × 96)    | 36 × 38 × 5<br>(91 × 96 × 13)     | 24 × 30 × 5<br>(61 × 76 × 13)   |
| Speed display font size | in.<br>(cm)          | 26<br>(66)              | 26<br>(66)              | 26<br>(66)              | 26<br>(66)              | 26<br>(66)              | 26<br>(66)                        | 13<br>(33)                      |
| Speed limit sign size†  | in.<br>(cm)          | 30 × 36<br>(76 × 91)    | 24 × 30<br>(61 × 76)    | 48 × 60<br>(122 × 152)  | 36 × 48<br>(91 × 122)   | 36 × 36<br>(91 × 91)    | As specified or customer-supplied |                                 |
| Power                   |                      | Batteries, solar        | Batteries, solar        | Batteries, solar        | Batteries, solar        | Batteries, solar        | Batteries, solar; or 110/220Vac   | Batteries, solar; or 110/220Vac |

Footprint size is L × W. Cabinet and sign sizes are W × H × D. \*Height includes YOUR SPEED sign. †Standard sign sizes shown, other sizes are optional. Contact the factory.

# Traffic Data Classifier System

## Traffic Counter & Data Analyzer

- Collects and classifies traffic data
- Nonintrusive and safe to install
- Analytic graphing
- Data analysis for any purpose
- Remote access with optional modem

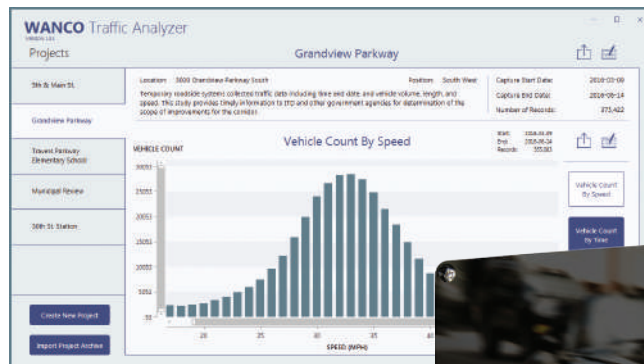

The Wanco Traffic Data Classifier System provides a safe, nonintrusive method for monitoring and analyzing traffic patterns. Employing side-fire radar to measure vehicle speed and length,\* the data collector uses no wires, loops or hoses. Analytic graphing software is included, making it easy to chart traffic data. The system integrates with any Wanco Message Sign or Speed Sign.

### Features and Benefits

#### Common applications

- Tool for traffic engineers to investigate lane flow, speed and density
- Use collected data to make decisions and recommendations for managing traffic
- Investigate and validate complaints from citizens, neighborhoods and contractors
- Planners can back up needs and recommendations with real data
- Decide when to put police on the roads
- Prove the need for traffic controls

#### Operation

- Nonintrusive, no disturbance of traffic flow during installation or use
- Radar-based design is less dangerous to install than loops and hoses
- Most effective for two-lane roads
- Counts both approaching and departing vehicles

\*Side-fire radar system captures date and time, traffic volume (count), and vehicle speed, direction and length

Registers millions of vehicles in internal memory

#### Data analysis

- Wanco Traffic Analyzer app included with system
- App installs on user-supplied computer
- Create and manage multiple projects at once
- Name projects and add details and notes when needed
- Analytic graphing charts vehicle count vs. speed, volume over time, and means & percentiles for easy analysis
- Filter data as desired
- Fully interactive graphs can be customized for your requirements
- Export graphs in common file formats



With optional modem, data can be retrieved remotely via the Internet. See page 8.



# Solar Camera Trailers

## Live Remote Video

Wireless remote viewing and monitoring

Integrates with existing video networks

Continuous unmanned operation

Easy to transport

Completely self-contained

Wanco Portable Camera Trailers provide remote site monitoring in a compact, mobile, self-contained unit. Where no permanent cameras are installed, these systems augment any video network with quick and easy deployment, and an array of remote-access capabilities that include GPS location and system telemetry. Perfect for DOTs, traffic engineers, ITS and signal engineers and others to remotely monitor traffic, work zones and weather conditions—all in real time. Wanco Camera Trailers feature rugged construction and electronics chosen specifically for transportation departments.

| Cameras          |  |
|------------------|--|
| Camera type      | Outdoor IP-network cameras<br>Day/night, pan-tilt-zoom (PTZ), 360° rotation                            |
| Camera height    | 20 ft. (6.1 m)   |
| Power system     |  |
| Batteries        | Four 4D AGM 12 Vdc batteries wired for 24 Vdc  |
| Battery capacity | 400 Ah total   |
| Solar array      | Two panels on tilt-frame<br>800 W total  |
| Options          |  |
| Popular options  | Choice of wireless communications<br>Onboard digital recording<br>Choice of cameras<br>Side-fire radar |

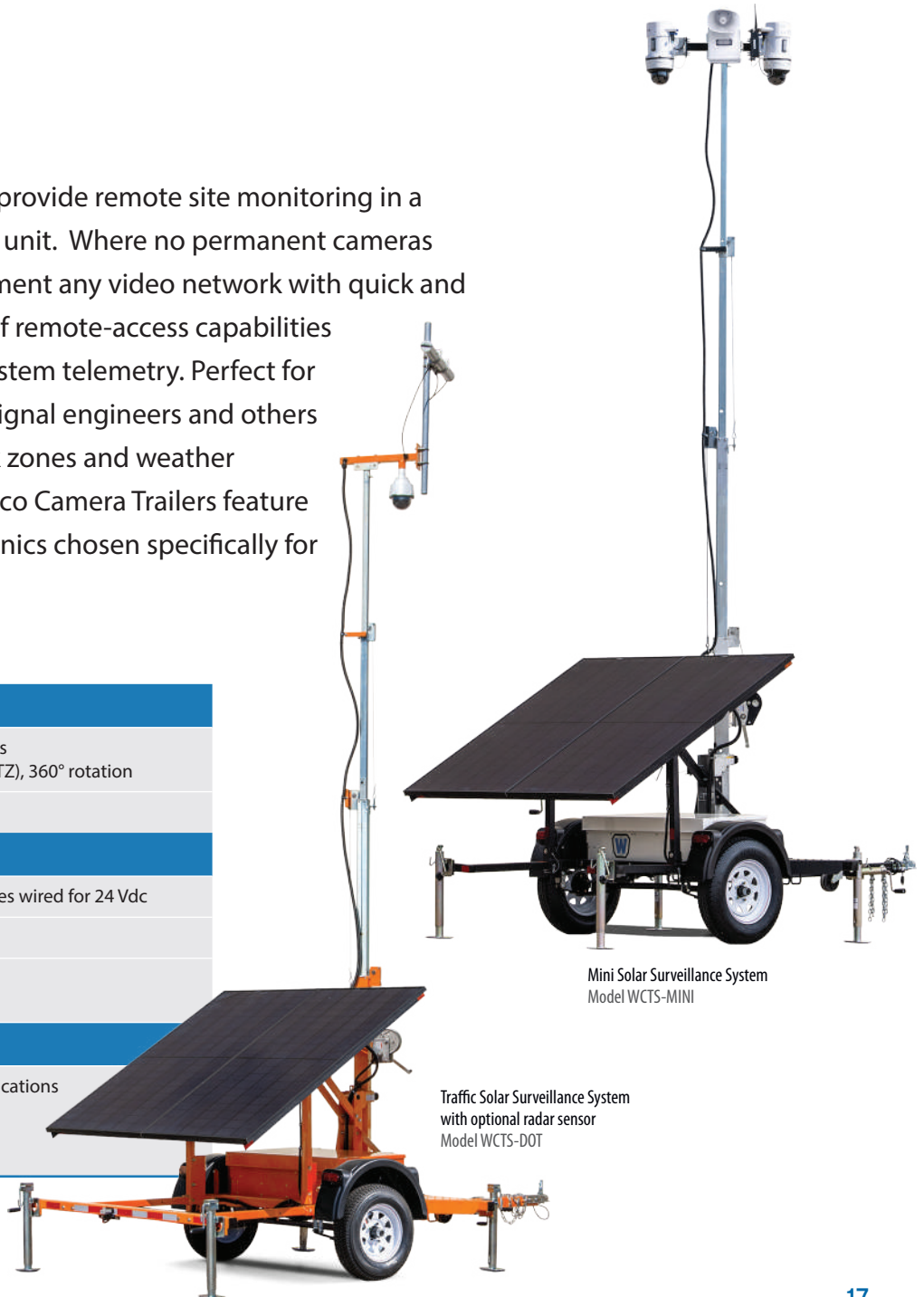

Mini Solar Surveillance System  
Model WCTS-MINI

Traffic Solar Surveillance System  
with optional radar sensor  
Model WCTS-DOT

# Diesel Light Towers

Vertical- and laydown-tower models

LED or metal halide lights

360-degree tower rotation

Lights operate at any height

Easy to transport

Wanco Diesel Light Towers use state-of-the-art technology for superior illumination. Models include vertical and laydown towers with LED or metal halide lights. Lights operate at any height and can be aimed independently without the use of tools. Energy efficient and easy to use, Wanco Light Towers are designed for optimum performance and maximum durability.

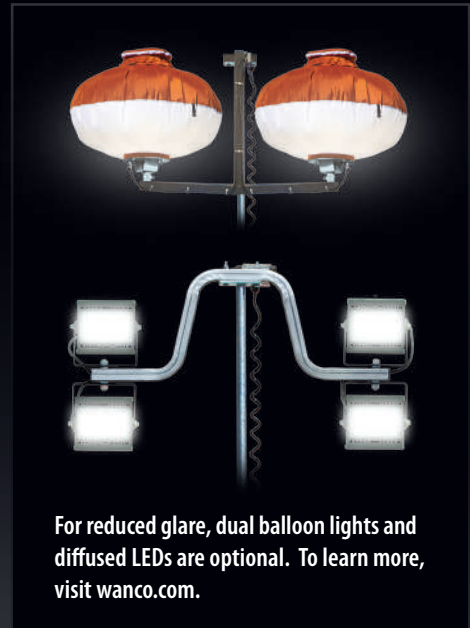

| Lights                    | All models                                      |  |
|---------------------------|---|--|
| LED                       | Four LED fixtures<br>350W or 480W per fixture*† |  |
| Metal halide              | Four metal halide fixtures<br>1000W per fixture |  |
| Physical                  | Compact models                                  | Laydown models                               |
| Deployed footprint, L x W | 111 x 129 in.<br>(281 x 327 cm)                 | 127 x 112 in.<br>(321 x 285 cm)              |
| Operating height          | max. 23 ft. (7.0 m)<br>min. 8 ft. (2.5 m)       | max. 30 ft. (9.1 m)<br>min. 12.5 ft. (3.8 m) |
| Travel height             | 97 in. (247 cm)                                 | 66 in. (168 cm)                              |
| Weight, approx.           | 1580 lbs. (717 kg)                              | 1800 lbs. (817 kg)                           |
| Power‡                    | 4 kW models                                     | 6 kW models                                  |
| Output power              | 4.0 kW  | 6.0 kW                                       |
| Output voltage            | 120 Vac   | 120/240 Vac                                  |
| Receptacle                | 120 V 20 A GFCI                                 | 120 V 20 A GFCI or<br>240 V twist-lock       |
| Run time, approx.         | up to 310 hours                                 | up to 240 hours                              |

\*Due to improvements in LED technology, light fixtures are subject to change.

†Depending on model. ‡8 kW models also available.

For more information, visit [wanco.com](http://wanco.com)



# Solar Light Towers

**Silent operation**

**Four LED lights on 20-foot tower**

**Compact trailer**

**Automatic and manual operating modes**

**Battery powered and solar charged**

Wanco's Small Solar Light Tower provides bright, concentrated LED light for night work. Solar light towers operate silently, which means they can be used in residential areas without disturbing the public. Common applications include utility site and road repairs, flagger stations, checkpoints and personal work areas. The Small Solar Light Tower features four high-efficiency light fixtures on a 20-foot telescoping tower. The lights can be individually aimed without tools. Autonomous operation is possible during summer.

| Lights                    |   |
|---------------------------|---|
| Light fixtures            | Four LED fixtures                             |
| Power draw, approx.       | 60 watts per light fixture*                   |
| Physical                  |   |
| Deployed footprint, L x W | 158 x 83 in. (401 x 211 cm)                   |
| Operating height          | max. 19.7 ft. (6.0 m)<br>min. 9 ft. (27 m)    |
| Travel height             | 108 in. (273 cm)                              |
| Weight, approx.           | 1680 lbs. (762 kg)                            |
| Power system              |   |
| Batteries                 | Four 4D AGM 12 Vdc batteries wired for 24 Vdc |
| Battery capacity          | 400 Ah total                                  |
| Solar array               | Two panels on tilt-frame<br>800 W total       |

\*Due to improvements in LED technology, light fixtures are subject to change. For more information, visit [wanco.com](http://wanco.com).



Small Solar Light Tower  
Model WLTS-SM



Wanco has many models of solar light towers with brighter lights, taller towers and larger trailers. Hybrid models feature integral diesel backup. To learn more, visit [wanco.com](http://wanco.com).

# Balloon Light Cart

Glare-free 360° illumination

Reduced and diffused shadows

18-foot telescoping tower

Steerable heavy-duty cart with brake

AC powered—generator or shore power

Wanco Balloon Lights provide diffused light that reduces shadows and eliminates glare, making night work safer and easier on the eyes. The balloon light illuminates large areas even at low operating heights. The tower can extend to over 18 feet and the light operates at any height. The light cart features a built-in handle, steerable wheels, flat-free all terrain tires and a foot-operated parking brake. With outriggers deployed, the heavy-duty steel base and low center of gravity keep the light and telescoping mast stable.

| Balloon Light                  |   |
|--------------------------------|---|
| Light type                     | LED   |
| Color temperature              | 5000K   |
| Luminosity                     | 65,000 lumens, 360° beam angle                    |
| Power draw                     | 650 watts   |
| Balloon size, inflated, W × H* | 40 × 29 in. (100 × 73 cm)                         |
| Weight, approx.                | 22 lbs. (10 kg)                                   |
| Light Cart                     |   |
| Deployed footprint, L × W      | 60 × 72 in. (152 × 183 cm)                        |
| Deployed height, tower only    | 15 ft. (4.6 m)                                    |
| Deployed height with balloon*  | 17 ft. 8 in. (5.4 m)                              |
| Travel size, L × W × H         | 50 × 32 × 67 in. (127 × 80 × 170 cm)              |
| Weight, approx.                | 208 lbs. (94 kg)                                  |
| Power                          |   |
| Power supply                   | Portable generator or Commercial AC power 120 Vac |

\*Balloon height does not include attached cover and pouch.



Balloon Light Cart  
Model WLC1000B

# X-Marker™

## L-893(L) Runway Closure Marker

FAA standards certified

Lowest fuel consumption in the industry

24-hour battery backup

10-year operating life for LED fixtures

Easy to deploy in under 5 minutes

The Wanco X-Marker™ is an L-893(L) lighted visual aid for indicating temporary runway closure. It efficiently and effectively warns pilots of closed airport runways and taxiways, and protects maintenance crews working in these areas. Based on proven Wanco generator technology, the X-Marker L-893(L) features the lowest fuel consumption and longest runtime in the industry. The X-Marker L-893(L) is ETL-certified to meet FAA AC 150/5345-55.

| Brief Specifications |   |
|----------------------|---|
| Lights               | Nine high-efficiency LED fixtures   |
| Luminosity           | 6000 lumens per fixture, 54,000 lumens total  |
| Operating height     | 20 ft. 5 in. (6.2 m)  |
| Arm length           | 21 ft. 8 in. (6.6 m) tip to tip   |
| Run time             | On engine power, up to 7 days before refueling<br>On backup battery power, additional 24 hours  |
| Popular options      | Tandem tow package<br>Integral fluid containment<br>Cold weather package<br>Polar weather package<br>Emergency stop<br>Protective cover |

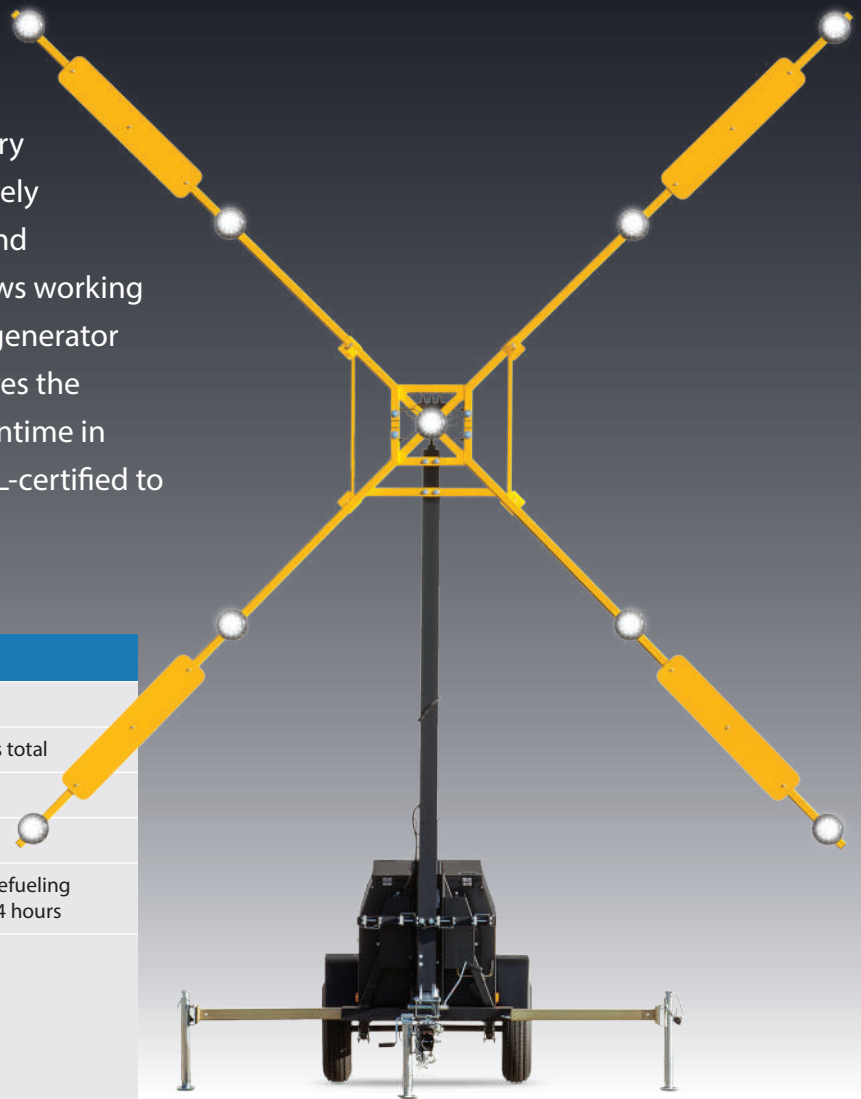

X-Marker L-893(L)  
Model WTRC

# Beacon Trailers

Quick setup and takedown

Compact and easy to tow

Solar charging system

Built to meet state requirements

Flashing beacons

Wanco Fold-n-Go™ Beacon Trailers provide a platform for displaying temporary signs, made more noticeable with bright, flashing beacons. Portable and extremely easy to tow, these trailers offer simple roadside placement. A variety of sign sizes can be attached.

Wanco can design beacon trailers to meet your requirements and local codes. Contact us to learn more.



Flashing Beacon Trailer  
for signs 48 inches wide  
Model WFNG-48-2L

Flashing Beacon Trailer  
for signs 36 inches wide  
Model WFNG-36-2L

# Mobile Generators

Robust rental-grade construction

Heavy-duty Tier 4 Final diesel engine

Enlarged fuel tank for maximum run times

Oversized PMG generator for superior starting

Sound attenuation reduces dB levels



Mobile Generator, 100 kW  
Model WSP140

Mobile Generator, 12 kW  
with folding drawbar  
Model WSP12

Every model features robust construction for reliable performance, a digital controller for monitoring and control, and continuous operating data on an easy-to-read display. Environmentally friendly features include a double-wall fuel tank with containment basin, and closed-cell foam insulation for impressive noise reduction. A choice of models provide power from 12 kilowatts up, available skid- or trailer-mounted.

# Caution Beacons



3-Head School Zone Beacon Kit  
Model WCBSZ-55-3L

**Kits for common applications**

**Permanent and temporary installations**

**Solar charging or AC powered**

**Simple controls**

**Automatic night dimming**

Wanco Caution Beacons are the right choice for school zones, construction sites and areas that require motorists' attention. Bright flashing beacons and simple controls, combined with a variety of options, make Wanco Beacons ideally suited for any application. Choose from preconfigured kits or select individual components as needed.

# Conversion Kits

Retrofit your older matrix and three-line signs of nearly any brand with new Wanco signs and touchscreen controller. Choose from four sign sizes. See our Message Sign Conversion Kits online or contact us for more information.

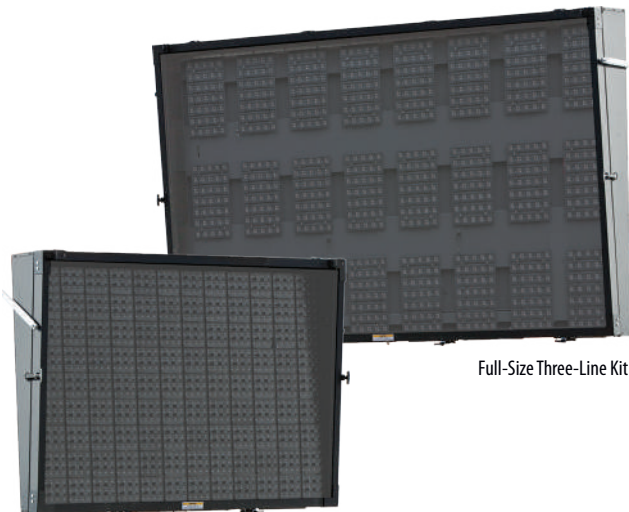

Mini Matrix Kit

Full-Size Three-Line Kit

# Accessories

Wanco offers accessories, auxiliary devices and options for enhancing the functionality of our equipment. Asset tracking, speed-detection radar and other useful accessories are available. Visit [wanco.com](http://wanco.com) or contact us to learn more.



Speed-Detection Radar

Asset Tracker

Compass



**WANCO INC.**  
5870 Tennyson Street  
Arvada, Colorado 80003 USA  
800-972-0755  
303-427-5700  
303-427-5725 fax  
[www.wanco.com](http://www.wanco.com)